



**Addendum # 3**  
**Bid Opportunity: 25-7692-RFT - Grand River**  
**Collegiate Institute Asbestos Removal for Family**  
**Studies Renovation**  
**Closing Date: Thursday, April 3, 2025 2:00 PM**

---

The following issued by the Board shall form part of the Bid / Proposal Solicitation document. The revisions and additions noted herein along with any attachments shall be read in conjunction with all other related documents. This Addendum shall, take precedence over the previously issued documents where differences occur. Receipt of this addendum must be acknowledged in the Bidding System, bids&tenders.

If you have already submitted a Bid / Proposal, it will be automatically withdrawn as a result of this addendum. You must resubmit the Bid / Proposal acknowledging all addenda and revising your Bid / Proposal to comply with all addenda.

**Question 1:**

The mechanical drawings do not indicate the removal or reinstallation of ductwork for this project. Since this is type 3 abatement will all existing ductwork have to be remediated and replaced with new.in the renovated areas?

**Answer 1:**

**There is no known ductwork in the area of work.**

**Question 2:**

Could you please provide the sizes of the beams on either side of Classroom 1-117 that will be receiving the fireproofing spray?

**Answer 2:**

**Refer to attached existing base building structural drawing indicating the sizes of the existing structure.**



SECOND FLOOR & LOW ROOF FRAMING PLAN - UNIT "A"

SCALE: 1/8" = 1'-0"

TOP OF FINISHED SECOND FLOOR TO BE AT ELEVATION 1039.01'  
TOP OF CONC. SLAB TO BE 1/2" BELOW TOP OF FINISHED SECOND FLOOR UNLESS OTHERWISE NOTED & NOTED.

OTHERWISE CROSS-SECTION NOTED.  
PIPS OF STEEL BEAMS TO BE 5/8" BELOW FIN. 2ND UNLESS NOTED THIS 1/2"

REINFORCED WITH #2 @ 10" O.C. - ENCL. JOISTS, UNLESS OTHERWISE NOTED, #10 B.B.

LIVE LOADS -

ROOF - 40 PSF

WAREHOUSE - 40 PSF

CORRIDOR - 40 PSF

MECH. ROOM - 100 PSF

ALL JOISTS ARE SHOWN THUSLY NOTED ON PLAN. JOISTS SHALL BE 6' O.C. WITH 1/2" BELOW FIN. 2ND UNLESS NOTED THIS 1/2"

IS LIVE LOAD PLUS DEAD LOAD IN POUNDS PER SQUARE FOOT (NOT INCLUDING WEIGHT OF JOISTS.)

1. ALL JOISTS ARE SHOWN THUSLY NOTED ON PLAN. JOISTS SHALL BE 6' O.C. WITH 1/2" BELOW FIN. 2ND UNLESS NOTED THIS 1/2"

IS LIVE LOAD PLUS DEAD LOAD IN POUNDS PER SQUARE FOOT (NOT INCLUDING WEIGHT OF JOISTS.)

1. ALL JOISTS ARE SHOWN THUSLY NOTED ON PLAN. JOISTS SHALL BE 6' O.C. WITH 1/2" BELOW FIN. 2ND UNLESS NOTED THIS 1/2"

IS LIVE LOAD PLUS DEAD LOAD IN POUNDS PER SQUARE FOOT (NOT INCLUDING WEIGHT OF JOISTS.)

1. ALL JOISTS ARE SHOWN THUSLY NOTED ON PLAN. JOISTS SHALL BE 6' O.C. WITH 1/2" BELOW FIN. 2ND UNLESS NOTED THIS 1/2"

IS LIVE LOAD PLUS DEAD LOAD IN POUNDS PER SQUARE FOOT (NOT INCLUDING WEIGHT OF JOISTS.)

1. ALL JOISTS ARE SHOWN THUSLY NOTED ON PLAN. JOISTS SHALL BE 6' O.C. WITH 1/2" BELOW FIN. 2ND UNLESS NOTED THIS 1/2"

IS LIVE LOAD PLUS DEAD LOAD IN POUNDS PER SQUARE FOOT (NOT INCLUDING WEIGHT OF JOISTS.)

1. ALL JOISTS ARE SHOWN THUSLY NOTED ON PLAN. JOISTS SHALL BE 6' O.C. WITH 1/2" BELOW FIN. 2ND UNLESS NOTED THIS 1/2"

IS LIVE LOAD PLUS DEAD LOAD IN POUNDS PER SQUARE FOOT (NOT INCLUDING WEIGHT OF JOISTS.)

1. ALL JOISTS ARE SHOWN THUSLY NOTED ON PLAN. JOISTS SHALL BE 6' O.C. WITH 1/2" BELOW FIN. 2ND UNLESS NOTED THIS 1/2"

IS LIVE LOAD PLUS DEAD LOAD IN POUNDS PER SQUARE FOOT (NOT INCLUDING WEIGHT OF JOISTS.)

1. ALL JOISTS ARE SHOWN THUSLY NOTED ON PLAN. JOISTS SHALL BE 6' O.C. WITH 1/2" BELOW FIN. 2ND UNLESS NOTED THIS 1/2"

IS LIVE LOAD PLUS DEAD LOAD IN POUNDS PER SQUARE FOOT (NOT INCLUDING WEIGHT OF JOISTS.)

1. ALL JOISTS ARE SHOWN THUSLY NOTED ON PLAN. JOISTS SHALL BE 6' O.C. WITH 1/2" BELOW FIN. 2ND UNLESS NOTED THIS 1/2"

IS LIVE LOAD PLUS DEAD LOAD IN POUNDS PER SQUARE FOOT (NOT INCLUDING WEIGHT OF JOISTS.)

1. ALL JOISTS ARE SHOWN THUSLY NOTED ON PLAN. JOISTS SHALL BE 6' O.C. WITH 1/2" BELOW FIN. 2ND UNLESS NOTED THIS 1/2"

IS LIVE LOAD PLUS DEAD LOAD IN POUNDS PER SQUARE FOOT (NOT INCLUDING WEIGHT OF JOISTS.)

1. ALL JOISTS ARE SHOWN THUSLY NOTED ON PLAN. JOISTS SHALL BE 6' O.C. WITH 1/2" BELOW FIN. 2ND UNLESS NOTED THIS 1/2"

IS LIVE LOAD PLUS DEAD LOAD IN POUNDS PER SQUARE FOOT (NOT INCLUDING WEIGHT OF JOISTS.)

1. ALL JOISTS ARE SHOWN THUSLY NOTED ON PLAN. JOISTS SHALL BE 6' O.C. WITH 1/2" BELOW FIN. 2ND UNLESS NOTED THIS 1/2"

IS LIVE LOAD PLUS DEAD LOAD IN POUNDS PER SQUARE FOOT (NOT INCLUDING WEIGHT OF JOISTS.)

1. ALL JOISTS ARE SHOWN THUSLY NOTED ON PLAN. JOISTS SHALL BE 6' O.C. WITH 1/2" BELOW FIN. 2ND UNLESS NOTED THIS 1/2"

IS LIVE LOAD PLUS DEAD LOAD IN POUNDS PER SQUARE FOOT (NOT INCLUDING WEIGHT OF JOISTS.)

1. ALL JOISTS ARE SHOWN THUSLY NOTED ON PLAN. JOISTS SHALL BE 6' O.C. WITH 1/2" BELOW FIN. 2ND UNLESS NOTED THIS 1/2"

IS LIVE LOAD PLUS DEAD LOAD IN POUNDS PER SQUARE FOOT (NOT INCLUDING WEIGHT OF JOISTS.)

1. ALL JOISTS ARE SHOWN THUSLY NOTED ON PLAN. JOISTS SHALL BE 6' O.C. WITH 1/2" BELOW FIN. 2ND UNLESS NOTED THIS 1/2"

IS LIVE LOAD PLUS DEAD LOAD IN POUNDS PER SQUARE FOOT (NOT INCLUDING WEIGHT OF JOISTS.)

1. ALL JOISTS ARE SHOWN THUSLY NOTED ON PLAN. JOISTS SHALL BE 6' O.C. WITH 1/2" BELOW FIN. 2ND UNLESS NOTED THIS 1/2"

IS LIVE LOAD PLUS DEAD LOAD IN POUNDS PER SQUARE FOOT (NOT INCLUDING WEIGHT OF JOISTS.)

1. ALL JOISTS ARE SHOWN THUSLY NOTED ON PLAN. JOISTS SHALL BE 6' O.C. WITH 1/2" BELOW FIN. 2ND UNLESS NOTED THIS 1/2"

IS LIVE LOAD PLUS DEAD LOAD IN POUNDS PER SQUARE FOOT (NOT INCLUDING WEIGHT OF JOISTS.)

1. ALL JOISTS ARE SHOWN THUSLY NOTED ON PLAN. JOISTS SHALL BE 6' O.C. WITH 1/2" BELOW FIN. 2ND UNLESS NOTED THIS 1/2"

IS LIVE LOAD PLUS DEAD LOAD IN POUNDS PER SQUARE FOOT (NOT INCLUDING WEIGHT OF JOISTS.)

1. ALL JOISTS ARE SHOWN THUSLY NOTED ON PLAN. JOISTS SHALL BE 6' O.C. WITH 1/2" BELOW FIN. 2ND UNLESS NOTED THIS 1/2"

IS LIVE LOAD PLUS DEAD LOAD IN POUNDS PER SQUARE FOOT (NOT INCLUDING WEIGHT OF JOISTS.)

1. ALL JOISTS ARE SHOWN THUSLY NOTED ON PLAN. JOISTS SHALL BE 6' O.C. WITH 1/2" BELOW FIN. 2ND UNLESS NOTED THIS 1/2"

IS LIVE LOAD PLUS DEAD LOAD IN POUNDS PER SQUARE FOOT (NOT INCLUDING WEIGHT OF JOISTS.)

1. ALL JOISTS ARE SHOWN THUSLY NOTED ON PLAN. JOISTS SHALL BE 6' O.C. WITH 1/2" BELOW FIN. 2ND UNLESS NOTED THIS 1/2"

IS LIVE LOAD PLUS DEAD LOAD IN POUNDS PER SQUARE FOOT (NOT INCLUDING WEIGHT OF JOISTS.)

1. ALL JOISTS ARE SHOWN THUSLY NOTED ON PLAN. JOISTS SHALL BE 6' O.C. WITH 1/2" BELOW FIN. 2ND UNLESS NOTED THIS 1/2"

IS LIVE LOAD PLUS DEAD LOAD IN POUNDS PER SQUARE FOOT (NOT INCLUDING WEIGHT OF JOISTS.)

1. ALL JOISTS ARE SHOWN THUSLY NOTED ON PLAN. JOISTS SHALL BE 6' O.C. WITH 1/2" BELOW FIN. 2ND UNLESS NOTED THIS 1/2"

IS LIVE LOAD PLUS DEAD LOAD IN POUNDS PER SQUARE FOOT (NOT INCLUDING WEIGHT OF JOISTS.)

1. ALL JOISTS ARE SHOWN THUSLY NOTED ON PLAN. JOISTS SHALL BE 6' O.C. WITH 1/2" BELOW FIN. 2ND UNLESS NOTED THIS 1/2"

IS LIVE LOAD PLUS DEAD LOAD IN POUNDS PER SQUARE FOOT (NOT INCLUDING WEIGHT OF JOISTS.)

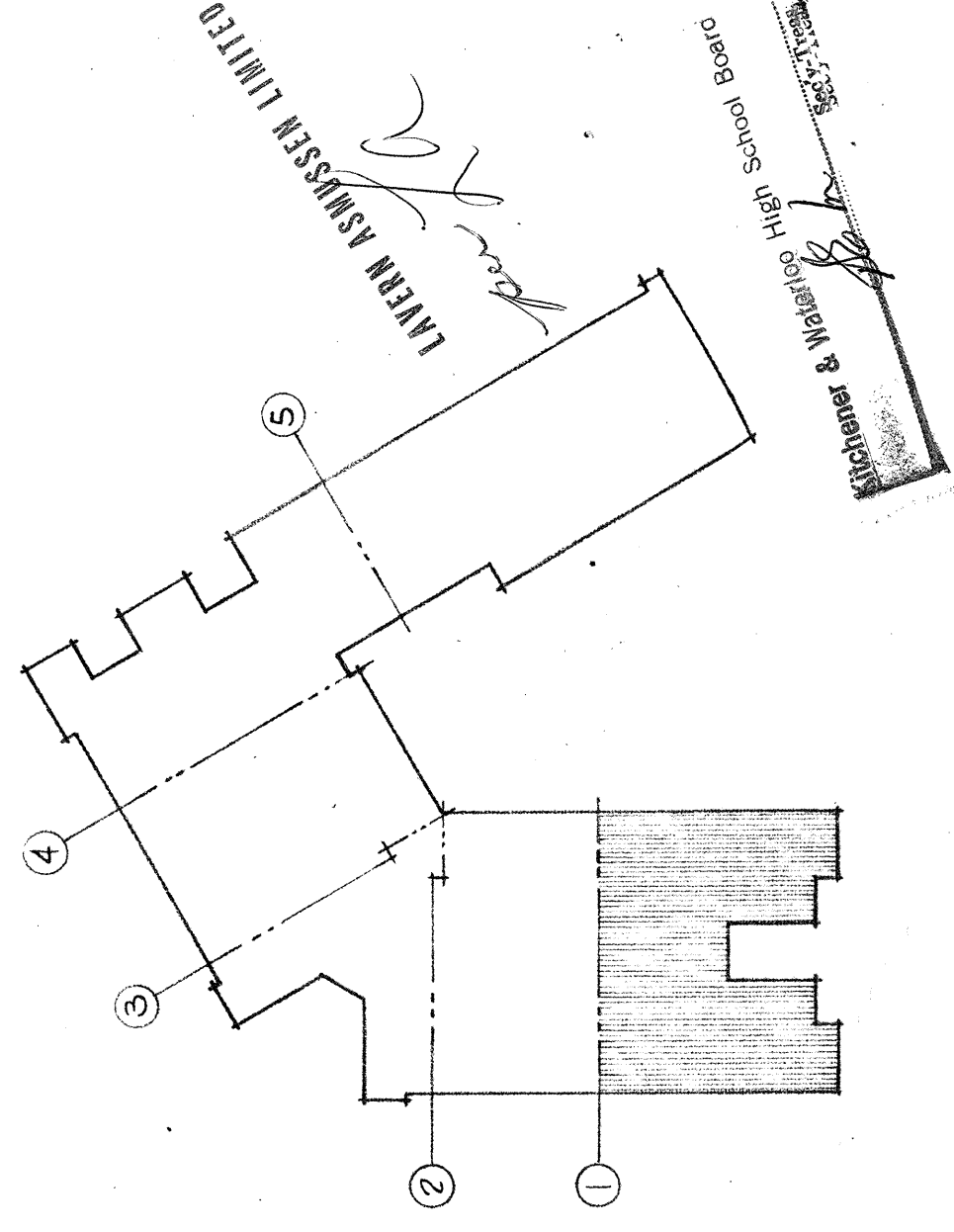

UNIT A

SCALE

AS NOTED

JOB

2-574-1

SHEET

S-4

DATE

APR 65

DRAWN BY

T.D.V.

CHECKED BY

E.W. HAYES

REGISTERED PROFESSIONAL ENGINEER

STRUCTURAL ENGINEERING

E.W. HAYES LIMITED

ARCHITECTS

REGISTERED PROFESSIONAL ARCHITECTS

NEW COLLEGIATE

K-W COLLEGIATE

NATCHEZ ROAD

KITCHENER