

St. Francis CES

298 Hwy 8, Stoney Creek, Ontario

CHIMNEY DEMOLITION



Read Jones Christoffersen Ltd.
Engineers
rjc.ca
100 University Avenue,
North Tower, Suite 300
Toronto, ON M5J 1V6 Canada
tel 416-977-5335
email toronto@rjc.ca

TORONTO · KITCHENER · KINGSTON ·
OTTAWA · MONTREAL · VANCOUVER ·
VICTORIA · NANAIMO · KELOWNA ·
SURREY · CALGARY · EDMONTON ·
SASKATOON · LONDON · HALIFAX ·
LAS VEGAS · PRINCE EDWARD ISLAND

LIST OF DRAWINGS :	
	COVER PAGE AND GENERAL NOTES
S1	SITE PLAN
S2	SOUTH ELEVATION
S3	SECTIONS AND DETAILS

<p>1.0 GENERAL NOTES :</p> <p>(THESE NOTES APPLY TO ALL PHASES / ASPECTS OF THE PROJECT)</p> <ol style="list-style-type: none"> THESE DRAWINGS ARE TO PROVIDE A SCHEMATIC REPRESENTATION OF THE APPROXIMATE LAYOUT OF THE BUILDING AND AREA OF WORK. THE CONTRACTOR MUST REVIEW AND CONFIRM THE EXTENT OF EXISTING SITE CONDITIONS THAT WILL AFFECT OR WILL REQUIRE ADJUSTMENT IN ORDER TO COMPLETE THE WORK AS SHOWN IN THE DOCUMENTS PRIOR TO BIDDING. DISCREPANCIES, AMBIGUITIES OR OMISSIONS IN THE DRAWINGS SHALL BE BROUGHT TO THE ATTENTION OF THE CONSULTANT IMMEDIATELY. PARTIAL COPIES OF THE ORIGINAL CONSTRUCTION DRAWINGS ARE AVAILABLE FOR VIEWING AND REFERENCE PURPOSES ONLY. DO NOT SCALE FROM THIS DRAWING OR RELY ON ANY DRAWINGS AS ACCURATELY REFLECTING THE AS-BUILT CONDITION. THE EXTENT OF WORK IS AS SHOWN ON THE DRAWINGS. HOARDING, DUST PROTECTION, SITE PROTECTION AND CONSTRUCTION SIGNAGE IS TO BE INSTALLED AROUND THE SITE AND PHASES OF WORK IN ACCORDANCE WITH SPECIFICATION SECTION 01 56 00, THESE NOTES AND THE DRAWINGS PRIOR TO COMMENCING THE WORK. THE CONTRACTOR WILL BE REQUIRED TO UNDERTAKE THE WORK SO AS TO MAINTAIN CONTINUOUS OPERATION OF ALL ENTRANCES/EXITS TO THE BUILDING. THIS SET OF DRAWINGS DOES NOT INCLUDE COMPONENTS THAT MAY BE NECESSARY FOR CONSTRUCTION SAFETY. THE CONTRACTOR IS RESPONSIBLE FOR SAFETY IN AND AROUND THE JOB SITE DURING CONSTRUCTION, AND FOR THE DESIGN AND ERECTION OF ALL TEMPORARY STRUCTURES REQUIRED TO COMPLETE THE WORK. THE USE OF THESE DRAWINGS IS LIMITED TO THE EXTENT IDENTIFIED IN THE REVISIONS COLUMNS. DO NOT CONSTRUCT FROM THESE DRAWINGS UNLESS MARKED "ISSUED FOR CONSTRUCTION" BY READ JONES CHRISTOFFERSEN LTD. ALL DIMENSIONS TAKEN FROM THE DRAWINGS SHALL BE CHECKED ON SITE PRIOR TO THE START OF WORK. THE CONTRACTOR SHALL BE RESPONSIBLE FOR THE CORRECTNESS OF SUCH MEASUREMENTS AND REPORT TO THE ENGINEER IN WRITING ALL DISCREPANCIES BETWEEN THE MEASUREMENTS AT THE BUILDING AND THOSE SHOWN ON THE DRAWINGS PRIOR TO COMMENCING THE WORK. THE CONTRACTOR SHALL REVIEW ALL THE DRAWINGS AND CHECK THE DIMENSIONS BEFORE CONSTRUCTION. REPORT ANY DISCREPANCIES BETWEEN THESE DRAWINGS AND THE SITE CONDITION TO THE CONSULTANT IMMEDIATELY. SECTION MARK SHOWN THUS $\frac{1}{S3}$ DENOTES SECTION 1 ON DRAWING S3. THE ENGINEERING FIELD SERVICES: THE ENGINEER WILL PROVIDE FIELD SERVICE DURING THE CONSTRUCTION PHASE OF THE WORK TO SATISFY THEMSELVES, BY MEANS OF A RATIONAL SAMPLING PROCEDURE WHICH THEY IN THEIR SOLE DISCRETION CONSIDER NECESSARY TO DETERMINE THAT THE CONTRACTOR IS CARRYING OUT THE WORK IN GENERAL CONFORMANCE WITH THE CONTRACT DOCUMENTS. THE FIELD SERVICES PROVIDED APPLY ONLY TO THAT WORK SHOWN ON RJC'S DRAWINGS. THE PERFORMANCE OF THE CONTRACT IS NOT THE ENGINEER'S RESPONSIBILITY, NOR ARE THE FIELD SERVICES RENDERED FOR THE CONTRACTOR'S BENEFIT. THE CONTRACTOR IS SOLELY RESPONSIBLE FOR QUALITY CONTROL AND PERFORMING THE WORK IN ACCORDANCE WITH THE CONTRACT DOCUMENTS. THE CONTRACTOR WILL BE RESPONSIBLE TO REPAIR/RESTORE/REPAINT ALL EXISTING FINISHES AND LANDSCAPING DAMAGED AS A RESULT OF CONSTRUCTION OR REMOVED IN ORDER TO ALLOW CONSTRUCTION TO BE UNDERTAKEN. THIS SET OF DRAWINGS ALONG WITH THE SPECIFICATIONS FORM THE CONTRACT DOCUMENTS AND MUST BE READ AND INTERPRETED IN CONJUNCTION WITH ONE ANOTHER. ALL WORK IS TO BE IN ACCORDANCE WITH THE 2024 ONTARIO BUILDING CODE. 	<p>2.0 GENERAL SCOPE OF WORK :</p> <ol style="list-style-type: none"> IN GENERAL, THIS REHABILITATION PROGRAM INCLUDES THE REMOVAL OF THE EXISTING CHIMNEY AND ASSOCIATED ROOFING AND CONCRETE REPAIRS. IN PARTICULAR, THE WORK, BRIEFLY DESCRIBED BELOW, INCLUDES, BUT IS NOT NECESSARILY LIMITED TO THE FOLLOWING: <ol style="list-style-type: none"> REMOVAL AND DISPOSAL OF THE EXISTING CHIMNEY AT LOCATION SHOWN ON THE DRAWINGS AND AS DIRECTED BY THE CONSULTANT LOCALIZED REPAIR OF THE ROOFING MEMBRANE AND METAL FLASHING AFTER DEMOLITION OF THE CHIMNEY IS COMPLETED AS SHOWN ON THE DRAWINGS AND AS DIRECTED BY THE CONSULTANT LOCALIZED CONCRETE REPAIRS BEHIND THE CHIMNEY AFTER DEMOLITION OF THE CHIMNEY IS COMPLETED AS SHOWN ON THE DRAWINGS AND AS DIRECTED BY THE CONSULTANT FINAL CLEANING OF THE STRUCTURE, FIXTURES, PIPING, ETC., AND THE DISPOSAL OF ALL WASTE PRODUCTS AND/OR DEBRIS GENERATED BY THE CONSTRUCTION ACTIVITY, AS WELL AS ANY MATERIAL PRESENT IN THE WORK AREA PRIOR TO THE COMMENCEMENT OF THE WORK. THE AREAS REQUIRING CLEANING SHALL CONSIST OF ALL AREAS AFFECTED BY THE WORK. <p>3.0 HOARDING NOTES :</p> <ol style="list-style-type: none"> HOARDING, DUST PROTECTION AND OVERHEAD PROTECTION IS REQUIRED PER SPECIFICATION SECTION 01 56 00, TO PROTECT THE PUBLIC FROM FALLING DEBRIS. OVERHEAD PROTECTION/COVERED WALKWAYS ARE TO BE PROVIDED AS REQUIRED IN ACCORDANCE WITH ALL BY-LAWS, STANDARDS, OCCUPATIONAL HEALTH AND SAFETY ACT, AND AS REQUIRED BY AUTHORITIES AND THESE SPECIFICATIONS. THIS INCLUDES COVERED WALKWAYS AT ALL ENTRANCES AND EXITS TO THE BUILDING. MAINTAIN A MINIMUM HALLWAY WIDTH OF 900MM (36") AT ALL TIMES DURING THE WORK. THE CONTRACTOR IS TO INSTALL CONSTRUCTION SIGNAGE ADVISING THE PUBLIC OF THE WORK BEING UNDERTAKEN. <p>4.0 EXISTING CONDITIONS :</p> <ol style="list-style-type: none"> THIS SET OF DRAWINGS IS BASED ON THE EXISTING DRAWINGS AVAILABLE AT THE TIME OF DESIGN AND THE LIMITED REVIEW UNDERTAKEN BY RJC. THE ASSUMED EXISTING CONDITIONS ARE SHOWN ON THE DRAWINGS. <p>5.0 CONCRETE / SHORING REPAIR NOTES :</p> <ol style="list-style-type: none"> BEFORE STARTING CONCRETE REMOVALS, REVIEW WITH RJC THE EFFECT OF DEMOLITION ON STRUCTURAL INTEGRITY. PROVIDE SHORING OF STRUCTURAL MEMBERS AS REQUIRED TO FACILITATE THE WORK. THE CONTRACTOR IS TO SUBMIT SHORING DESIGN FOR RJC TO REVIEW PRIOR TO INSTALLATION. ALL REQUIRED SHORING MUST BE INSTALLED PRIOR TO CONCRETE REMOVAL. IN ADDITION TO REPAIRS SHOWN ON THE DRAWINGS, RANDOMLY LOCATED CONCRETE DELAMINATION REPAIRS ARE TO BE PERFORMED IN LOCALIZED AREAS IN ACCORDANCE WITH THE APPROPRIATE DETAIL AS DIRECTED BY THE CONSULTANT. <p>6.0 SITE REVIEW RESPONSIBILITY :</p> <p>READ JONES CHRISTOFFERSEN LIMITED ("RJC") WILL PROVIDE GENERAL REVIEW OF CONSTRUCTION IN ACCORDANCE WITH THE PERFORMANCE STANDARDS OF THE ASSOCIATION OF PROFESSIONAL ENGINEERS OF ONTARIO BY MEANS OF A RATIONAL SAMPLING PROCEDURE TO DETERMINE WHETHER THE CONSTRUCTION OF THAT WORK SHOWN ON RJC'S DRAWINGS IS IN GENERAL CONFORMANCE WITH THE PLANS, SKETCHES, DRAWINGS, AND SPECIFICATIONS FORMING PART OF THE CONTRACT DOCUMENTS PREPARED BY RJC. THE CONTRACTOR IS SOLELY RESPONSIBLE FOR QUALITY CONTROL AND THE PERFORMANCE OF THE WORK IN ACCORDANCE WITH THE CONTRACT. RJC SHALL NOT BE RESPONSIBLE FOR THE ACTS OR OMISSIONS OF THE CONTRACTOR, SUBCONTRACTOR OR ANY OTHER PERSONS PERFORMING ANY OF THE WORK OR FOR THE FAILURE OF ANY OF THEM TO CARRY OUT THE WORK IN ACCORDANCE WITH THE CONTRACT DOCUMENTS.</p>	<p>7.0 TEMPORARY WORK :</p> <ol style="list-style-type: none"> THE CONTRACTOR SHALL DESIGN, PROVIDE, ERECT, MAINTAIN, REMOVE AND ASSUME FULL AND SOLE RESPONSIBILITY FOR ALL TEMPORARY WORK REQUIRED FOR THE SAFE AND COMPLETE EXECUTION OF THE WORK. IN THE EXECUTION OF THE TEMPORARY WORK AND FOR THE DURATION OF THE CONTRACT, THE CONTRACTOR SHALL MAKE ADEQUATE PROVISION FOR ALL LIKELY CONSTRUCTION LOADING AND PROVIDE SUFFICIENT BRACING AND PROPS TO KEEP THE WORK PLUMB, ALIGNED AND FREE FROM EXCESSIVE DEFLECTION. ACCESS OF HEAVY CONSTRUCTION EQUIPMENT AND ACCUMULATION OF CONSTRUCTION MATERIALS ON THE FLOORS ARE NOT PERMITTED, UNLESS SUCH HAVE BEEN CATERED FOR IN THE CONTRACTOR'S TEMPORARY WORK DESIGN TO THE SATISFACTION OF THE ENGINEER. COSTS OF ALL TEMPORARY WORK IS TO BE INCLUDED IN THE CONTRACT PRICE. SUBMIT SHOP DRAWINGS FOR ALL TEMPORARY WORK FOR REVIEW BEFORE FABRICATION COMMENCES. SHOP DRAWINGS SHALL BE SEALED BY A PROFESSIONAL ENGINEER LICENSED IN THE PROVINCE OF ONTARIO. <p>8.0 SIGNAGE NOTES :</p> <p>* * * DENOTES CONSTRUCTION SIGN LOCATION</p> <ol style="list-style-type: none"> THE CONTRACTOR SHALL PROVIDE ALL REQUIRED SIGNAGE NECESSARY TO PROTECT THE PUBLIC FROM THE CONSTRUCTION, CONTROL TRAFFIC FLOW THROUGH THE SITE AND THE WORK AREA, AND TO INFORM PATRONS THAT CONSTRUCTION ACTIVITY IS IN PROGRESS. ADDITIONAL SIGNS MAY BE REQUIRED AT THE DISCRETION OF THE OWNER OR THE CONSULTANT AS CONSTRUCTION PROGRESSES TO ENSURE VEHICLE AND PEDESTRIAN TRAFFIC FLOW IS MAINTAINED. NO EXTRAS WILL BE ENTERTAINED FOR SIGNAGE REQUIREMENTS AFTER TENDER CLOSES. SIGNAGE WILL BE REQUIRED AT ALL ENTRANCES TO THE BUILDING, STOREFRONTS, STAIRWELLS, ETC. THIS SIGNAGE SHALL CONSIST OF THE STANDARD "MEN AT WORK" SIGN WITH AN ADDITIONAL SIGN (SPECIAL ORDER) INDICATING THAT THE "SITE IS TEMPORARILY UNDER CONSTRUCTION" AND "WE ARE SORRY FOR THE INCONVENIENCE". SIGNAGE IS REQUIRED AT ALL BUILDING ENTRANCES TO THE WORK AREA. SIGNS ARE TO INDICATE THAT "THIS ENTRANCE IS CLOSED DUE TO CONSTRUCTION". THE LOCATION AND TYPE OF SITE SPECIFIC CONSTRUCTION SIGNAGE IS INDICATED ON THE PHASING DRAWINGS WHICH INCLUDES, BUT IS NOT NECESSARILY LIMITED TO THE FOLLOWING: <ol style="list-style-type: none"> "GARAGE TEMPORARILY UNDER CONSTRUCTION - SORRY FOR THE INCONVENIENCE" "THIS AREA OF PARKING GARAGE IS CLOSED FOR REPAIRS" "NO PARKING" (WITH DIRECTIONAL ARROW) "CAUTION, TWO-WAY TRAFFIC" "EXIT" (WITH DIRECTIONAL ARROW)
--	---	---

ISSUED FOR CLIENT REVIEW - January 27, 2026



RJC PROJECT No. TOR.143567.0001

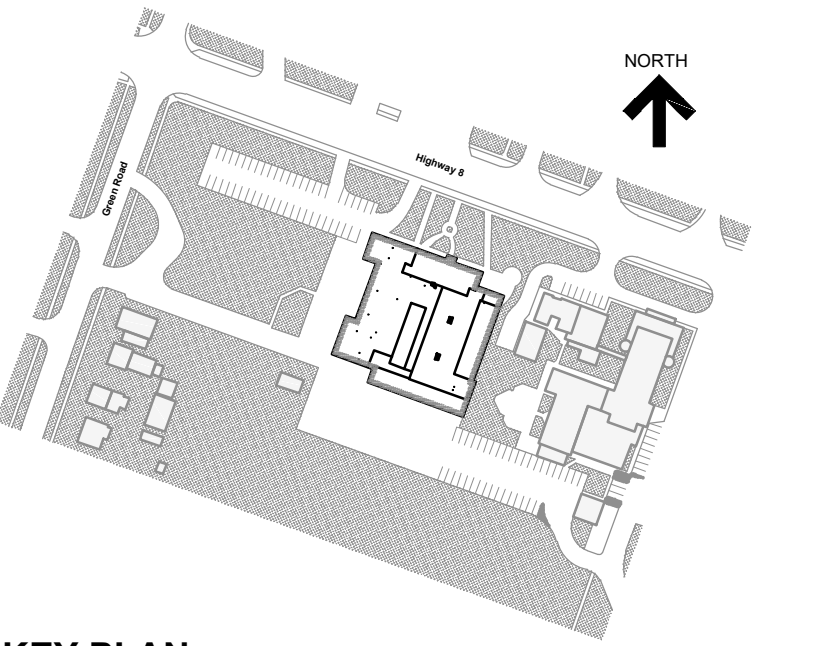

KEY PLAN

No.	Revision	Date	By
1.	ISSUED FOR CLIENT REVIEW	Jan. 27, 26	J.W.

- Drawing Notes**
- All drawings, plans, models, designs, specifications and other documents prepared by Read Jones Christoffersen Ltd. ("RJC") and used in connection with this project are instruments of service for the work shown in them (the "Work") and as such are and remain the property of RJC whether the Work is executed or not, and RJC reserves the copyright in them and in the Work executed from them, and they shall not be used for any other work or project.
 - These drawings are "design drawings" only. They may not be suitable for use as shop drawings. Use of these drawings as base drawings for "shop drawings" is not permitted unless written permission containing certain conditions and limitations is obtained from RJC. The work "as constructed" may vary from what is shown on these drawings.
 - Use of these drawings is limited to that identified in the Revision column. Do not construct from these drawings unless marked "Issued for Construction" by RJC in the Revision column, and then only for the parts noted. The drawings shall not be used for "pricing", "costing", or "tender" unless so indicated in the Revision column. "Pricing" or "Costing" drawings are not complete and any prices based on such drawings must allow for this.

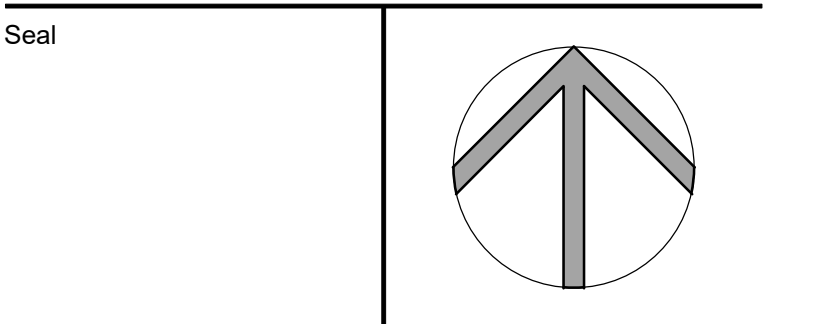

Project Name
St. Francis CES
298 Highway 8,
Stoney Creek, Ontario

**BRICK CHIMNEY
DEMOLITION**

Sheet Title

SITE PLAN

Drawn By L.O. Scale 1:200
Designed By J.W. Date January 2026
RJC Project Number **TOR.143567.0001**

Sheet Number **S1** Revision

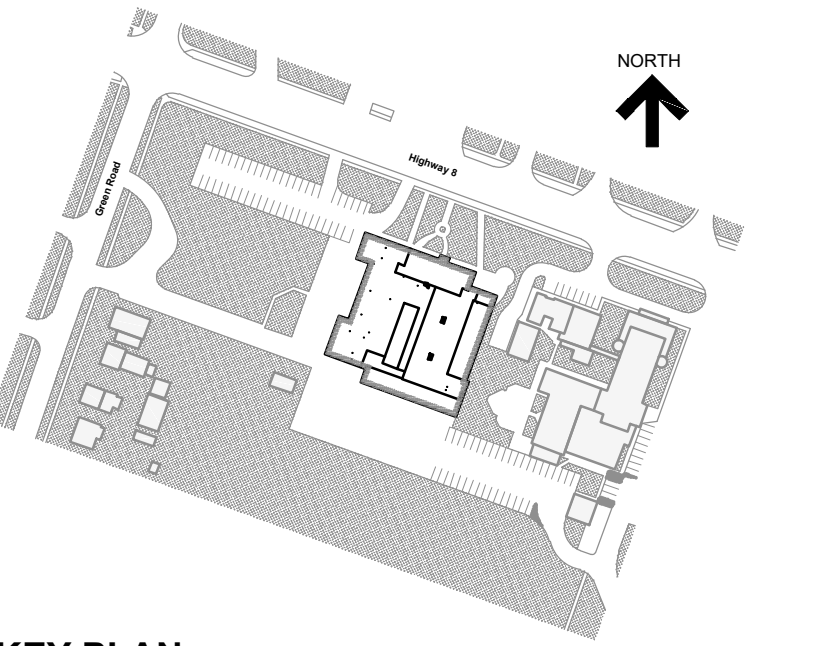

KEY PLAN

No.	Revision	Date	By
1.	ISSUED FOR CLIENT REVIEW	Jan. 27, 26	J.W.

Drawing Notes

- All drawings, plans, models, designs, specifications and other documents prepared by Read Jones Christoffersen Ltd. ("RJC") and used in connection with this project are instruments of service for the work shown in them (the "Work") and as such are and remain the property of RJC whether the Work is executed or not, and RJC reserves the copyright in them and in the Work executed from them, and they shall not be used for any other work or project.
- These drawings are "design drawings" only. They may not be suitable for use as shop drawings. Use of these drawings as base drawings for "shop drawings" is not permitted unless written permission containing certain conditions and limitations is obtained from RJC. The work "as constructed" may vary from what is shown on these drawings.
- Use of these drawings is limited to that identified in the Revision column. Do not construct from these drawings unless marked "Issued for Construction" by RJC in the Revision column, and then only for the parts noted. The drawings shall not be used for "pricing", "costing", or "tender" unless so indicated in the Revision column. "Pricing" or "Costing" drawings are not complete and any prices based on such drawings must allow for this.

Seal

Project Name
St. Francis CES
298 Highway 8,
Stoney Creek, Ontario

**BRICK CHIMNEY
DEMOLITION**

Sheet Title

SOUTH ELEVATION

Drawn By L.O. Scale 1:100
Designed By J.W. Date January 2026
RJC Project Number **TOR.143567.0001**

Sheet Number Revision

S2

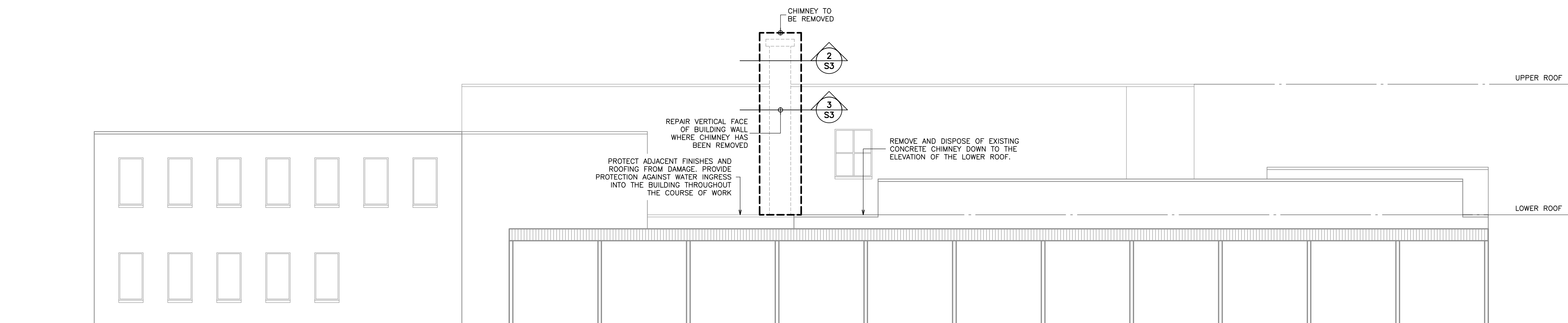

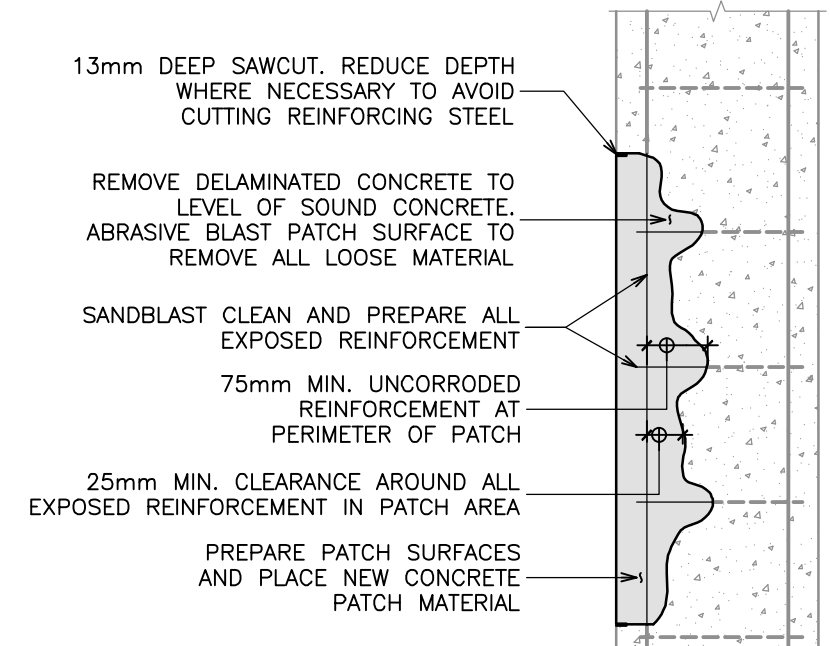

3
S3 TYPICAL VERTICAL CONCRETE DELAMINATION REPAIR DETAIL
N.T.S.

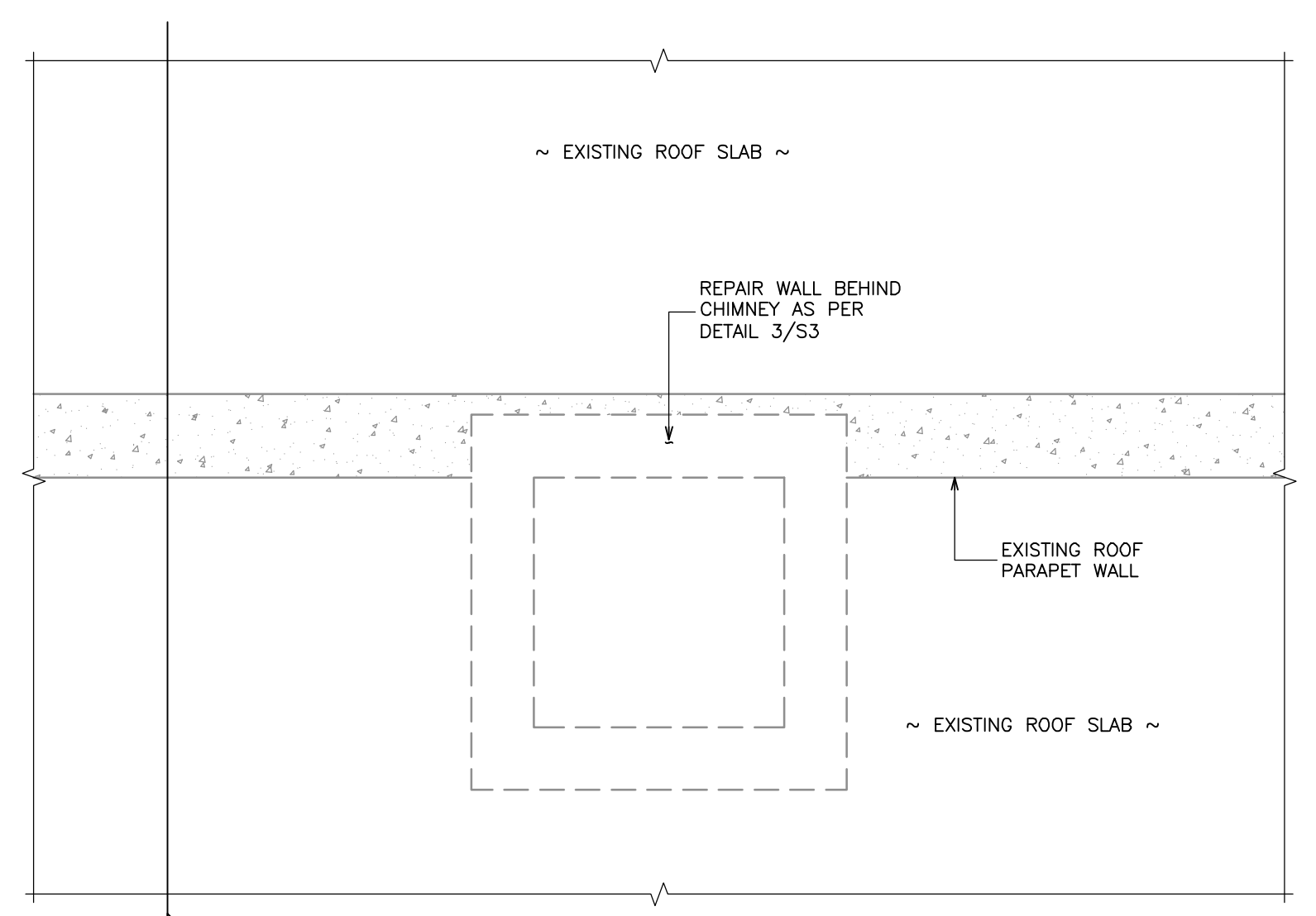

2
S3 CHIMNEY DEMOLITION DETAIL - SECTION VIEW
N.T.S.

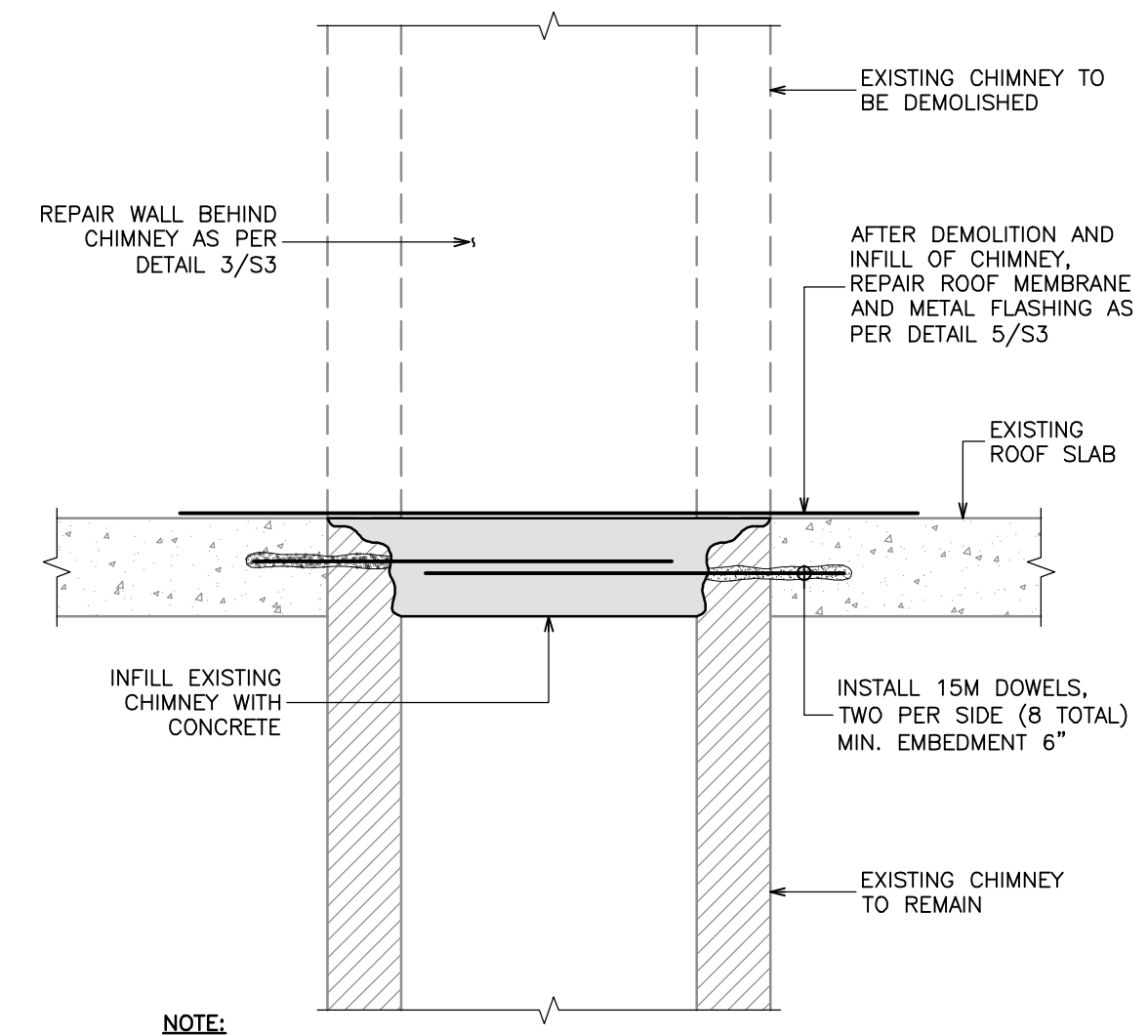

NOTE:
1. CONCRETE ROOF DECK SHOWN. DETAIL IS SIMILAR FOR STEEL DECK - INFILL OPENING WITH NEW STEEL DECKING TO MATCH EXISTING - REMOVE CONCRETE TO DEPTH OF BOTTOM OF STEEL DECKING.

1
S3 CHIMNEY DEMOLITION DETAIL - SECTION VIEW
N.T.S.

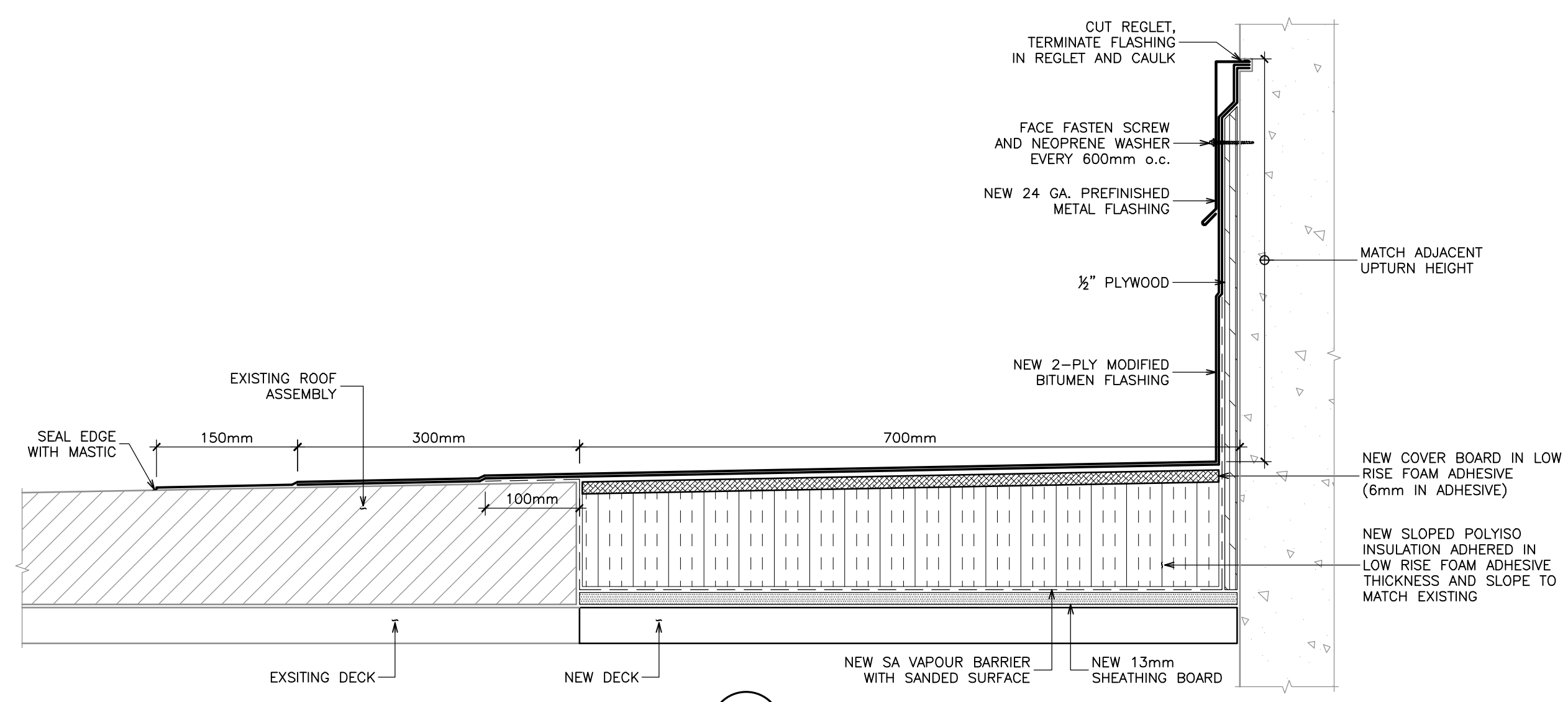

5
S3 UPTURN DETAIL
N.T.S.

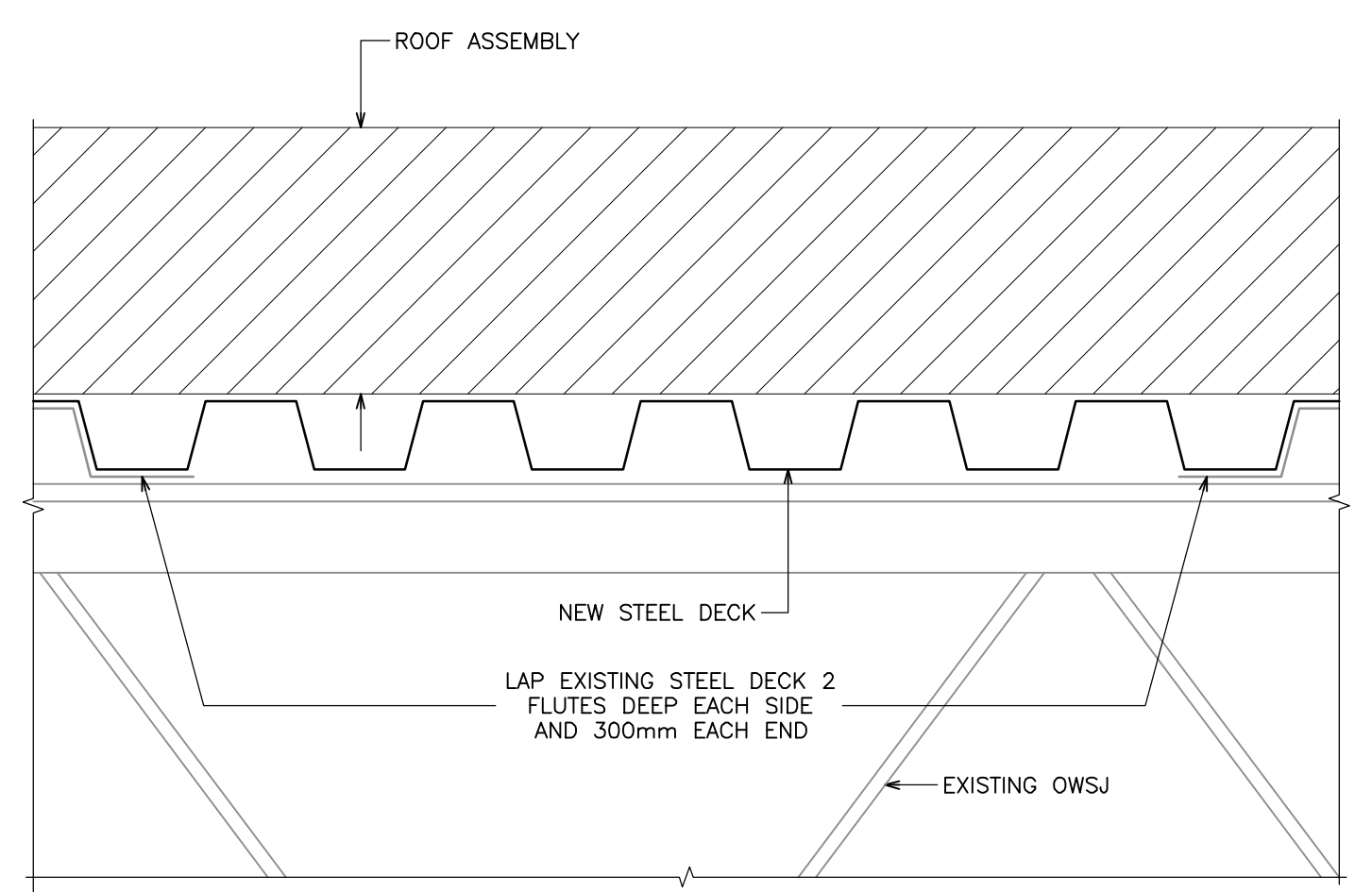

6
S3 TYPICAL ISOLATED DECK REPLACEMENT
N.T.S.

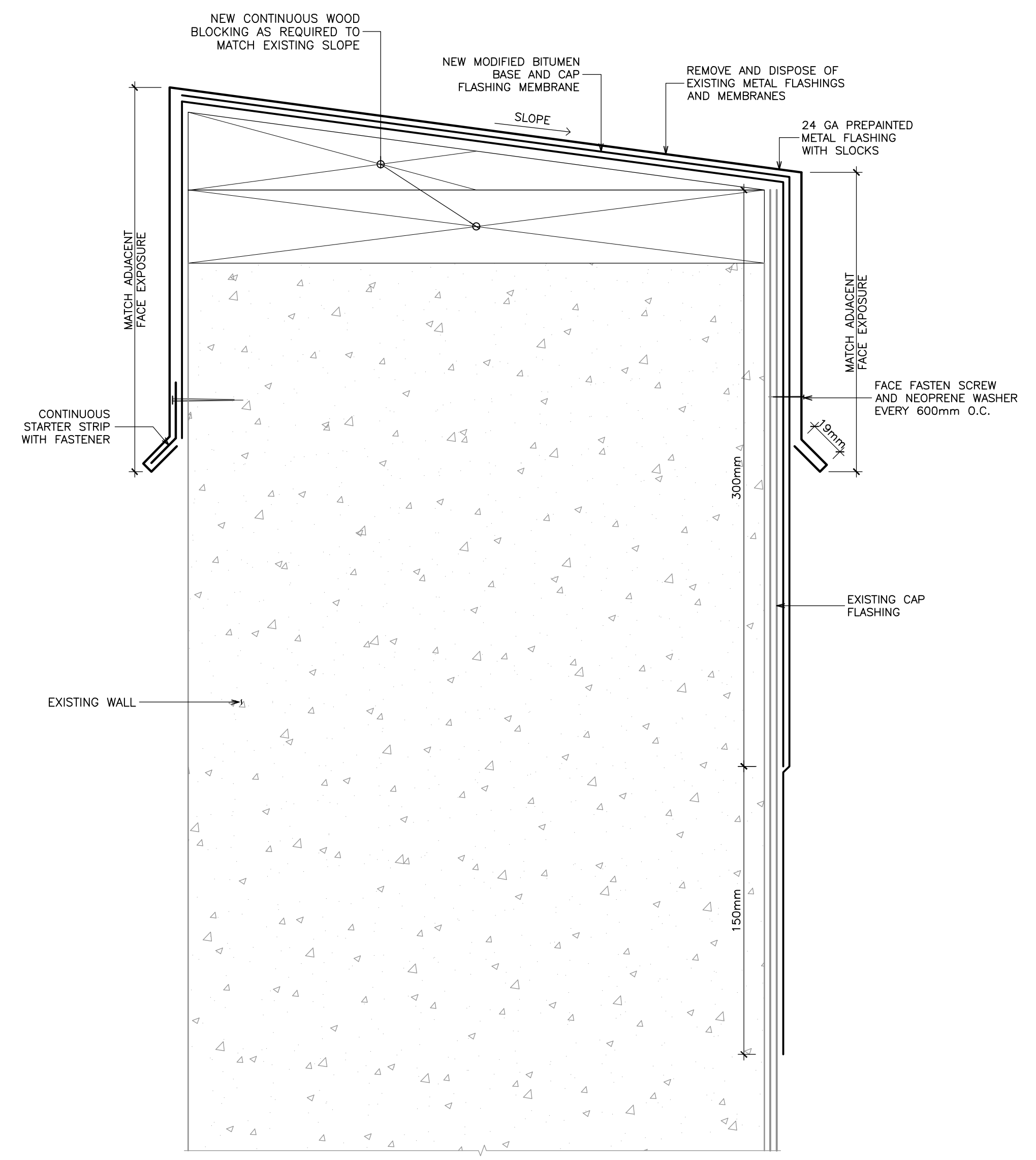

4
S3 PARAPET
N.T.S.



Read Jones Christoffersen Ltd.
Engineers
rjc.ca
100 University Avenue,
North Tower, Suite 300
Toronto, ON M5J 1V6 Canada
tel 416-977-5335
email toronto@rjc.ca

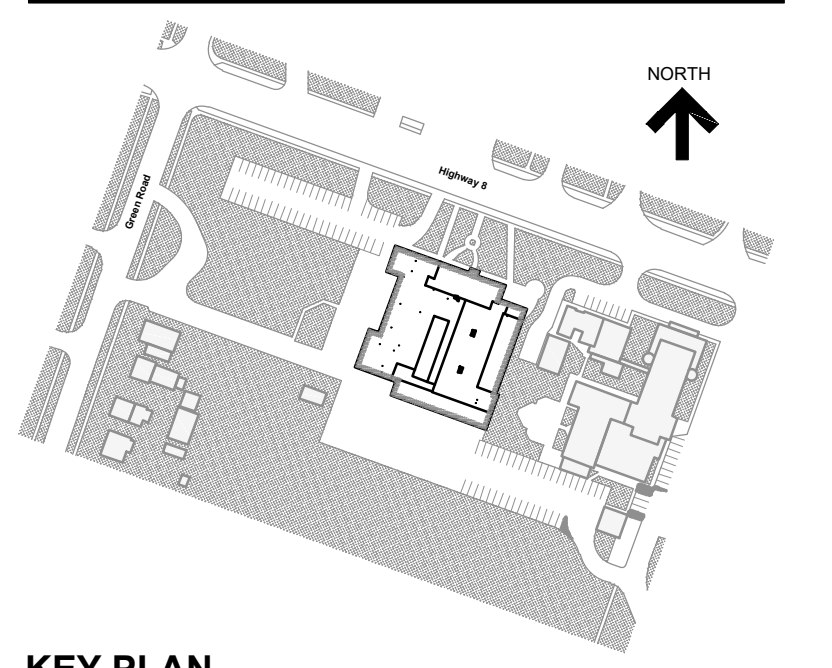

KEY PLAN

No.	Revision	Date	By
1.	ISSUED FOR CLIENT REVIEW	Jan. 27, 26	J.W.

Drawing Notes

- All drawings, plans, models, designs, specifications and other documents prepared by Read Jones Christoffersen Ltd. ("RJC") and used in connection with this project are instruments of service for the work shown in them (the "Work") and as such are and remain the property of RJC whether the Work is executed or not, and RJC reserves the copyright in them and in the Work executed from them, and they shall not be used for any other work or project.
- These drawings are "design drawings" only. They may not be suitable for use as shop drawings. Use of these drawings as base drawings for "shop drawings" is not permitted unless written permission containing certain conditions and limitations is obtained from RJC. The work "as constructed" may vary from what is shown on these drawings.
- Use of these drawings is limited to that identified in the Revision column. Do not construct from these drawings unless marked "Issued for Construction" by RJC in the Revision column, and then only for the parts noted. The drawings shall not be used for "pricing", "costing", or "tender" unless so indicated in the Revision column. "Pricing" or "Costing" drawings are not complete and any prices based on such drawings must allow for this.

Seal

Project Name
St. Francis CES
298 Highway 8,
Stoney Creek, Ontario

BRICK CHIMNEY DEMOLITION

Sheet Title

SECTIONS AND DETAILS

Drawn By L.O. Scale AS NOTED
Designed By J.W. Date January 2026
RJC Project Number **TOR.143567.0001**

Sheet Number Revision
S3